



**PINNACLE
REALTY**
OF NEW YORK, LLC

EXCLUSIVE LISTING

FOR LEASE



1776 HOE AVENUE

BRONX, NY 10460

Prime Warehouse on Boston Road For Lease

28,000 Sq. Ft. Warehouse
Plus Parking.

Type

Warehouse / Industrial



SQUARE FOOT

28,000_{RSF}



CLEAR HEIGHT

16'



LOADING

2 DRIVE-INS

4 LOADING DOCKS



ZONING

C8-3



PARCEL ID

2991

BLOCK



34

LOT

PRICE

Upon Request

718-784-8282 / PINNACLERENY.COM

All information is from sources deemed reliable and is submitted subject to errors, omission, changes of price or other conditions, prior sale, rent and withdrawal without notice.

Property Overview

Features

- **Lot Size:**
52,500 Sq. Ft.
- **Building Size:**
Approx. 28,000 Sq. Ft.
- Parking Available
- Offices Throughout
- L.E.D. Lighting
- Heavy Power
- Easy Loading
- Street to Street Access
- 2 Blocks From the Subway

Ideal For

- Storage & Distribution
- Parking
- Manufacturing
- Showroom/Warehousing
- Non-Profits & More!

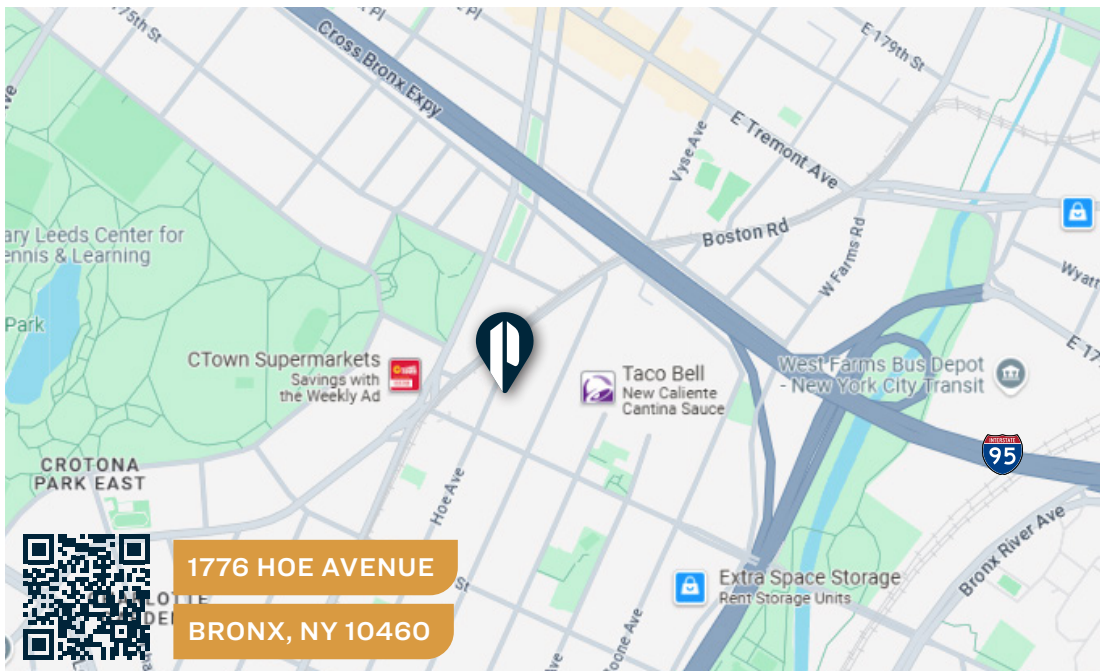
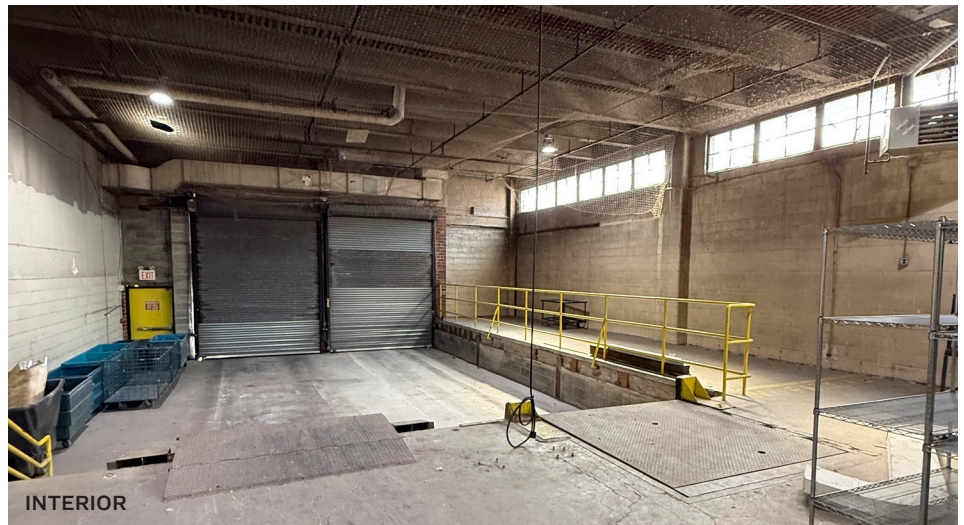

TRANSPORTATION

2 5 174 STREET/
BOSTON ROAD

 CROSS BRONX
EXPRESSWAY
SHERIDAN BLVD
BRONX RIVER
PKWY

 **BX 19:** SOUTHERN
BLVD/E 174 ST
BX 11, BX 21:
BOSTON RD/
SOUTHERN BLVD

AERIAL VIEW



**PINNACLE
REALTY**
OF NEW YORK, LLC

34-07 Steinway Street, Suite 202
Long Island City, NY 11101
718-784-8282
pinnaclereny.com

FOR MORE INFORMATION ABOUT THIS
PROPERTY CONTACT EXCLUSIVE AGENTS:



ARIEL CASTELLANOS
Associate Broker
acastellanos@pinnaclereny.com
718-371-6412



FEDERICO MAZZEO
Salesperson
fmazzeo@pinnaclereny.com
718-371-6424